

|                     |           |           |
|---------------------|-----------|-----------|
| PROJECT NO.         | SHEET NO. | TOTAL NO. |
| 2023CPT.11.03.10051 | 1         | 2         |
| 2023CPT.11.03.20051 |           |           |

### SUMMARY OF QUANTITIES

| PROJECT NO                                    | COUNTY | MAP NO | ROUTE  | ROUTE NAME | DESCRIPTION                           | FROM MILEPOST | TO MILEPOST | TYP NO | LANES | LANE TYPE | FINAL SURFACE TESTING REQUIRED | LENGTH | WIDTH       | 0106000000-E | 1220000000-E          | 1245000000-E            | 1330000000-E       | 1519000000-E          | 1520000000-E                | 1575000000-E                 | 1704000000-E               | 6084000000-E    |             |
|---|--------|--------|--------|------------|---------------------------------------|---------------|-------------|--------|-------|-----------|--------------------------------|--------|-------------|--------------|-----------------------|-------------------------|--------------------|-----------------------|-----------------------------|------------------------------|----------------------------|-----------------|-------------|
|   |        |        |        |            |                                       |               |             |        |       |           |                                |        |             | BORROW       | INCIDENTAL STONE BASE | SHOULDER RECONSTRUCTION | INCIDENTAL MILLING | SURFACE COURSE, S9.5B | LEVELING COURSE, TYPE S9.5B | ASPHALT BINDER FOR PLANT MIX | PATCHING EXISTING PAVEMENT | SEED & MULCHING |             |
|   |        |        |        |            |                                       |               |             |        |       |           |                                |        | MI          | FT           | CY                    | TONS                    | SMI                | SY                    | TONS                        | TON                          | TON                        | TONS            | AC          |
| 2023CPT.11.03.10051                           | Ashe   | 1      | US 221 | US 221     | FROM SR 1571 TO ALLEGHANY COUNTY LINE | 21.75         | 26.80       | 1      | 2     | 2WU       | NO                             | 5.05   | 20          | 1,010        | 101                   | 10.10                   | 667                | 5,657                 |                             | 379                          | 1,439                      | 3.79            |             |
| <b>TOTAL FOR PROJ NO. 2023CPT.11.03.10051</b> |        |        |        |            |                                       |               |             |        |       |           |                                |        | <b>5.05</b> |              | <b>1,010</b>          | <b>101</b>              | <b>10.10</b>       | <b>667</b>            | <b>5,657</b>                |                              | <b>379</b>                 | <b>1,439</b>    | <b>3.79</b> |

|   |      |   |         |                          |  |   |      |   |   |     |    |      |             |     |            |           |             |            |              |              |            |      |             |
|---|------|---|---------|--------------------------|--|---|------|---|---|-----|----|------|-------------|-----|------------|-----------|-------------|------------|--------------|--------------|------------|------|-------------|
| 2023CPT.11.03.20051                           | Ashe | 2 | SR 1196 | Nikanor Rd               | FROM NC 163 TO EOM                           | 0 | 0.99 | 1 | 2 | 2WU | NO | 0.99 | 18          | 198 | 20         | 1.98      | 100         | 999        | 433          | 96           |            | 0.74 |             |
| 2023CPT.11.03.20051                           | Ashe | 3 | SR 1350 | Charlie King Rd          | FROM SR 1347 TO BR# 346 OVER BIG HORSE CREEK | 0 | 1.03 | 1 | 2 | 2WU | NO | 1.03 | 19          | 206 |            | 2.06      | 211         | 1,096      | 475          | 105          |            | 0.77 |             |
| 2023CPT.11.03.20051                           | Ashe | 4 | SR 1582 | Friendship Baptist Ch Rd | FROM US 221 TO SR 1583                       | 0 | 0.69 | 1 | 2 | 2WU | NO | 0.69 | 18          | 138 | 14         | 1.38      | 100         | 696        | 302          | 67           |            | 0.52 |             |
| 2023CPT.11.03.20051                           | Ashe | 5 | SR 1583 | Ashe Central School Rd   | FROM SR 1582 TO US 221                       | 0 | 1.27 | 1 | 2 | 2WU | NO | 1.27 | 18          | 258 | 26         | 2.58      | 100         | 1,301      | 564          | 125          |            | 0.97 |             |
| 2023CPT.11.03.20051                           | Ashe | 6 | SR 1655 | Frank Witherspoon Rd     | FROM SR 1582 TO EOM                          | 0 | 0.13 | 2 | 2 | 2WU | NO | 0.13 | 18          | 26  | 3          | 0.26      |             | 104        | 57           | 11           |            | 0.10 |             |
| 2023CPT.11.03.20051                           | Ashe | 7 | SR 1671 | Witherspoon Heights Rd   | FROM SR 1655 TO EOM                          | 0 | 0.26 | 2 | 2 | 2WU | NO | 0.26 | 18          | 52  | 5          | 0.52      |             | 209        | 114          | 22           |            | 0.20 |             |
| <b>TOTAL FOR PROJ NO. 2023CPT.11.03.20051</b> |      |   |         |                          |  |   |      |   |   |     |    |      | <b>4.37</b> |     | <b>878</b> | <b>68</b> | <b>8.78</b> | <b>511</b> | <b>4,405</b> | <b>1,945</b> | <b>426</b> |      | <b>3.29</b> |

|                    |  |  |  |  |  |  |  |  |  |  |  |             |  |              |            |              |              |               |              |            |              |             |
|--------------------|--|--|--|--|--|--|--|--|--|--|--|-------------|--|--------------|------------|--------------|--------------|---------------|--------------|------------|--------------|-------------|
| <b>GRAND TOTAL</b> |  |  |  |  |  |  |  |  |  |  |  | <b>9.42</b> |  | <b>1,888</b> | <b>169</b> | <b>18.88</b> | <b>1,178</b> | <b>10,062</b> | <b>1,945</b> | <b>805</b> | <b>1,439</b> | <b>7.08</b> |
|--------------------|--|--|--|--|--|--|--|--|--|--|--|-------------|--|--------------|------------|--------------|--------------|---------------|--------------|------------|--------------|-------------|

|                     |           |           |
|---------------------|-----------|-----------|
| PROJECT NO.         | SHEET NO. | TOTAL NO. |
| 2023CPT.11.03.10051 | 2         | 2         |
| 2023CPT.11.03.20051 |           |           |

## THERMOPLASTIC AND PAINT QUANTITIES

| PROJECT NO                                    | COUNTY | MAP NO | ROUTE  | ROUTE NAME | DESCRIPTION                              | FROM MILEPOST | TO MILEPOST | TYP NO | LANES | LANE TYPE | LENGTH      | WIDTH | 4413000000-E                                     | 4457000000-N                 | 4810000000-E      |                    | 4895000000-N   |
|---|--------|--------|--------|------------|--|---------------|-------------|--------|-------|-----------|-------------|-------|--|------------------------------|-------------------|--------------------|--|
|   |        |        |        |            |  |               |             |        |       |           |             |       | WORK ZONE<br>ADVANCE/ GENERAL<br>WARNING SIGNING | TEMPORARY TRAFFIC<br>CONTROL | 4" WHITE<br>PAINT | 4" YELLOW<br>PAINT | GENERIC MARKING<br>ITEM NON-CAST<br>IRON SNOW<br>PLOWABLE MARKER |
|   |        |        |        |            |  |               |             |        |       |           |             | SF    | LS   | LF                           | LF                | EA                 |  |
| 2023CPT.11.03.10051                           | Ashe   | 1      | US 221 | US 221     | FROM SR 1571 TO ALLEGHANY<br>COUNTY LINE | 21.75         | 26.8        | 1      | 2     | 2WU       | 5.05        | 20    | 657  | 1                            | 108,676           | 108,676            | 470  |
| <b>TOTAL FOR PROJ NO. 2023CPT.11.03.10051</b> |        |        |        |            |  |               |             |        |       |           | <b>5.05</b> |       | <b>657</b>                                       | <b>1</b>                     | <b>108,676</b>    | <b>108,676</b>     | <b>470</b>   |
|   |        |        |        |            |  |               |             |        |       |           |             |       |  |                              |                   | <b>217,352</b>     |  |

|   |      |   |         |                          |   |   |      |   |   |     |             |    |            |  |               |                |  |
|---|------|---|---------|--------------------------|---|---|------|---|---|-----|-------------|----|------------|--|---------------|----------------|--|
| 2023CPT.11.03.20051                           | Ashe | 2 | SR 1196 | Nikanor Rd               | FROM NC 163 TO EOM                              | 0 | 0.99 | 1 | 2 | 2WU | 0.99        | 18 | 129        |  | 21,520        | 21,520         |  |
| 2023CPT.11.03.20051                           | Ashe | 3 | SR 1350 | Charlie King Rd          | FROM SR 1347 TO BR# 346 OVER<br>BIG HORSE CREEK | 0 | 1.03 | 1 | 2 | 2WU | 1.03        | 19 | 134        |  | 22,166        | 22,166         |  |
| 2023CPT.11.03.20051                           | Ashe | 4 | SR 1582 | Friendship Baptist Ch Rd | FROM US 221 TO SR 1583                          | 0 | 0.69 | 1 | 2 | 2WU | 0.69        | 18 | 90         |  | 14,849        | 14,849         |  |
| 2023CPT.11.03.20051                           | Ashe | 5 | SR 1583 | Ashe Central School Rd   | FROM SR 1582 TO US 221                          | 0 | 1.27 | 1 | 2 | 2WU | 1.27        | 18 | 168        |  | 27,761        | 27,761         |  |
| 2023CPT.11.03.20051                           | Ashe | 6 | SR 1655 | Frank Witherspoon Rd     | FROM SR 1582 TO EOM                             | 0 | 0.13 | 2 | 2 | 2WU | 0.13        | 18 | 17         |  |               |                |  |
| 2023CPT.11.03.20051                           | Ashe | 7 | SR 1671 | Wither spoon Heights Rd  | FROM SR 1655 TO EOM                             | 0 | 0.26 | 2 | 2 | 2WU | 0.26        | 18 | 34         |  |               |                |  |
| <b>TOTAL FOR PROJ NO. 2023CPT.11.03.20051</b> |      |   |         |                          |   |   |      |   |   |     | <b>4.37</b> |    | <b>572</b> |  | <b>86,296</b> | <b>86,296</b>  |  |
|   |      |   |         |                          |   |   |      |   |   |     |             |    |            |  |               | <b>172,592</b> |  |

|                    |  |  |  |  |  |  |  |  |  |  |  |             |  |              |          |                |                |            |
|--------------------|--|--|--|--|--|--|--|--|--|--|--|-------------|--|--------------|----------|----------------|----------------|------------|
| <b>GRAND TOTAL</b> |  |  |  |  |  |  |  |  |  |  |  | <b>9.42</b> |  | <b>1,229</b> | <b>1</b> | <b>194,972</b> | <b>194,972</b> | <b>470</b> |
|                    |  |  |  |  |  |  |  |  |  |  |  |             |  |              |          | <b>389,944</b> |                |            |

8/17/99

- \* "PATCHING EXISTING PAVEMENT" HAS BEEN INCLUDED AS A PAY ITEM ON MAPS. PATCHING MAY OR MAY NOT BE NEEDED DEPENDING ON CONDITION OF MAP SURFACE AT TIME THAT PAVING SEASON BEGINS. AREAS TO BE DELINIATED BY THE ENGINEER.
- \* INCIDENTAL MILLING AT LOCATIONS AS DIRECTED BY THE ENGINEER
- \* ON ANY MAP WITH SIGNALIZED INTERSECTIONS RESURFACE BEYOND FOOTPRINT OF VEHICLE DETECTION LOOPS
- \*\* LEVELING AT LOCATIONS AS DIRECTED BY ENGINEER THE ENGINEER

| PAVEMENT SCHEDULE |  |
|-------------------|--|
| C1                | PROP. APPROX. 1½" ASPHALT CONCRETE SURFACE COURSE, TYPE S9.5B, AN AVERAGE RATE OF 165 LBS. PER SQ. YD. |
| T                 | SHOULDER RECONSTRUCTION  |
| U                 | EXISTING PAVEMENT  |
| V3                | INCIDENTAL MILLING<br>(See Tie in Detail)  |

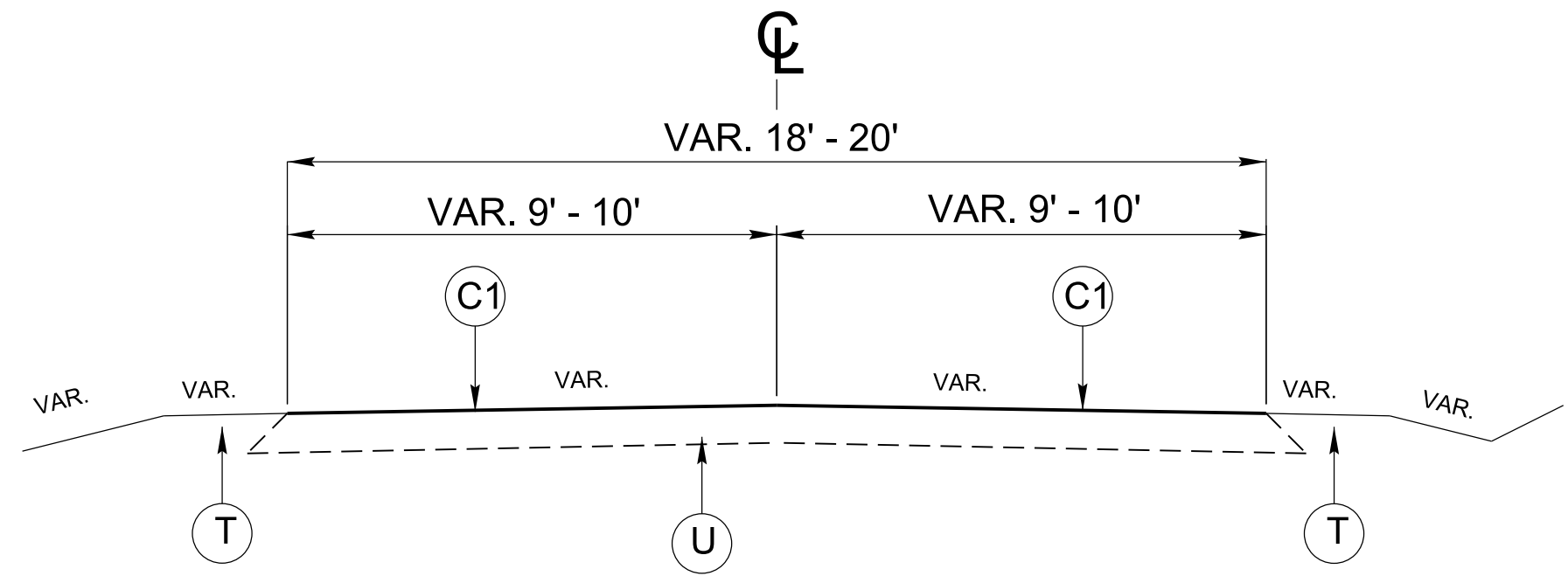

## TYPICAL SECTION NO. 1

MAP 1 - US 221 FROM SR 1571 TO ALLEGHANY COUNTY LINE

- \*\* MAP 2 - SR 1196 NIKANOR RD FROM NC 163 TO EOM (CUL-DE-SAC)
- \*\* MAP 3 - SR 1350 CHARLIE KING RD FROM SR 1347 TO BRIDGE #346 OVER BIG HORSE CREEK
- \*\* MAP 4 - SR 1582 FRIENDSHIP BAPTIST CH RD FROM US 221 TO SR 1583
- \*\* MAP 5 - SR 1583 ASHE CENTRAL SCHOOL RD FROM SR 1582 TO US 221

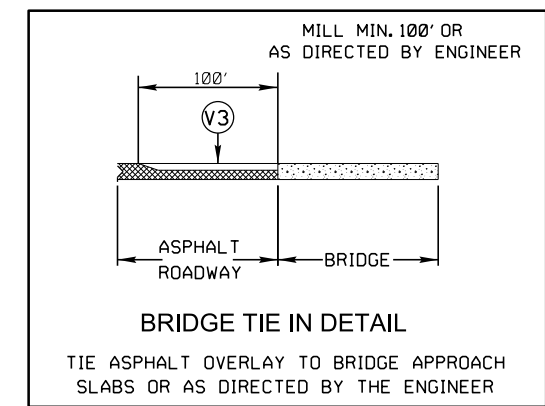
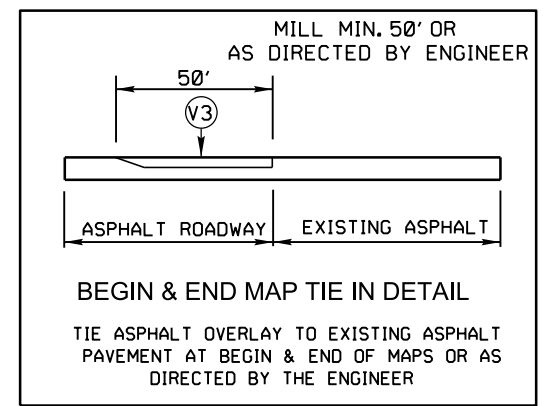

NOTE: TYPICALS ARE NOT TO SCALE

|  |  |   |
|--|--|---|
| ASHE COUNTY<br>PRIMARY & SECONDARY ROADS<br>2023 ASPHALT RESURFACING         |  |   |
| REVISIONS      INT.      DATE  |  |   |
| N.C. DEPARTMENT OF TRANSPORTATION<br>DIVISION OF HIGHWAYS<br>DIVISION ELEVEN |  | SCALE: N/A      DATE: 8/16/2022<br>PREPARED BY: DON<br>REVIEWED BY: |

SYSTEMS TIME 8/16/2022 10:00 AM

- \* INCIDENTAL MILLING AT LOCATIONS AS DIRECTED BY THE ENGINEER
- \*\* LEVELING AT LOCATIONS AS DIRECTED BY ENGINEER THE ENGINEER

| PAVEMENT SCHEDULE |  |
|-------------------|--|
| C2                | PROP. APPROX. 1.25" ASPHALT CONCRETE SURFACE COURSE, TYPE S9.5B, AN AVERAGE RATE OF 137.5 LBS. PER SQ. YD. |
| U                 | EXISTING PAVEMENT  |
| V3                | INCIDENTAL MILLING<br>(See Tie in Detail)  |

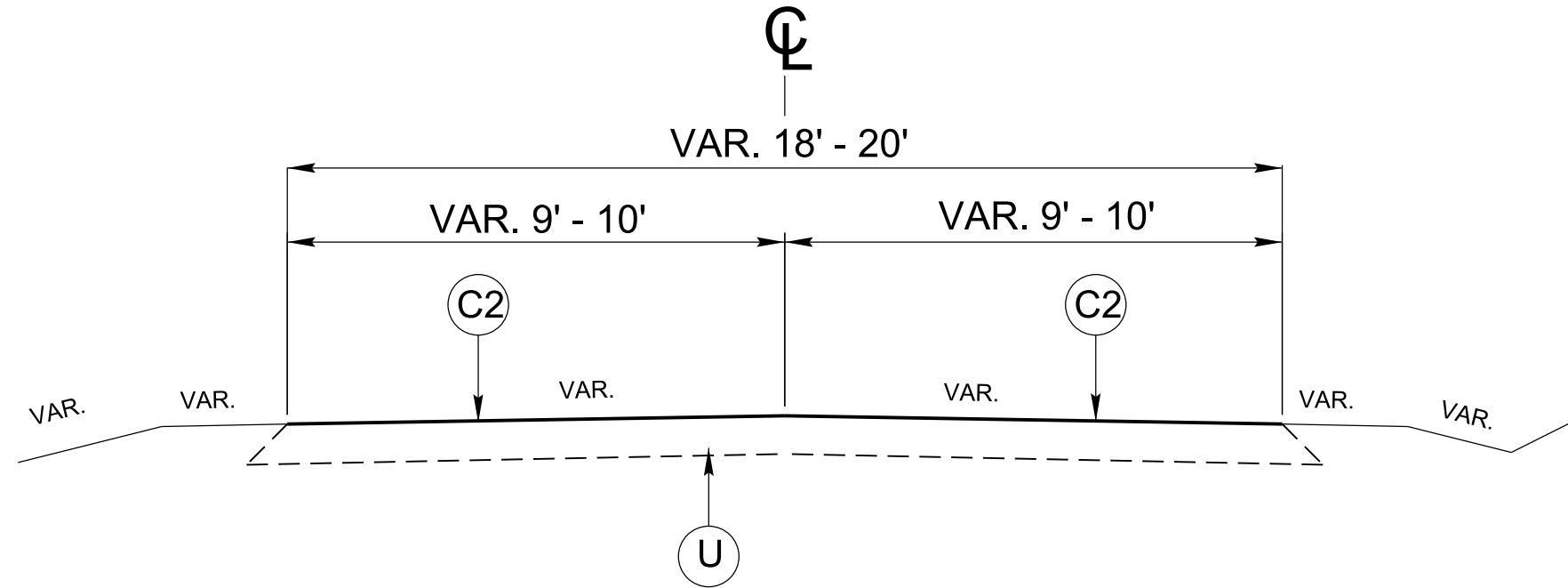

## TYPICAL SECTION NO. 2

- \*\* MAP 6 - SR 1655 FRANK WITHERSPOON RD FROM SR 1582 TO EOM
- \*\* MAP 7 - SR 1671 WITHERSPOON HEIGHTS RD FROM SR 1655 TO EOM

(Note: Shoulder Reconstruction is not intended on Maps 6 & 7; however, it has been added as a contingency quantity in the contract.)

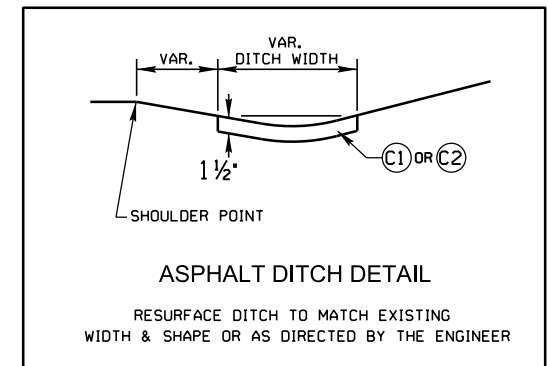
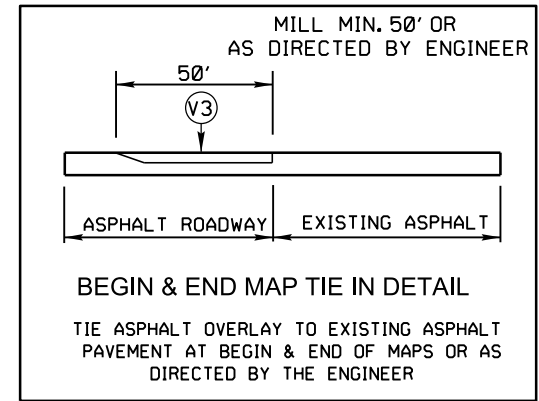

NOTE: TYPICALS ARE NOT TO SCALE

| ASHE COUNTY<br>PRIMARY & SECONDARY ROADS<br>2023 ASPHALT RESURFACING   |      |   |           |      |      |  |  |  |  |  |  |  |  |
|--|------|---|-----------|------|------|--|--|--|--|--|--|--|--|
| <table border="1" style="width: 100%;"> <thead> <tr> <th>REVISIONS</th> <th>INT.</th> <th>DATE</th> </tr> </thead> <tbody> <tr><td> </td><td> </td><td> </td></tr> <tr><td> </td><td> </td><td> </td></tr> <tr><td> </td><td> </td><td> </td></tr> </tbody> </table> |      |   | REVISIONS | INT. | DATE |  |  |  |  |  |  |  |  |
| REVISIONS  | INT. | DATE  |           |      |      |  |  |  |  |  |  |  |  |
|  |      |   |           |      |      |  |  |  |  |  |  |  |  |
|  |      |   |           |      |      |  |  |  |  |  |  |  |  |
|  |      |   |           |      |      |  |  |  |  |  |  |  |  |
| N.C. DEPARTMENT OF TRANSPORTATION<br>DIVISION OF HIGHWAYS<br>DIVISION ELEVEN   |      | SCALE: N/A    DATE: 8/16/2022<br>PREPARED BY: DON<br>REVIEWED BY: |           |      |      |  |  |  |  |  |  |  |  |

\*\* (Note: Asphalt Ditches may be present on any map. In such cases, the contractor is to clean ditches and refer to the corresponding detail for construction guidance as directed by the engineer. )

8/17/99

\$\$\$\$\$\$SYTIME\$\$\$\$\$  
 \$\$\$\$\$\$DATE\$\$\$\$\$  
 \$\$\$\$\$\$TIME\$\$\$\$\$  
 \$\$\$\$\$\$PAGE\$\$\$\$\$  
 \$\$\$\$\$\$TOTAL\$\$\$\$\$  
 \$\$\$\$\$\$COUNT\$\$\$\$\$  
 \$\$\$\$\$\$TOTAL\$\$\$\$\$  
 \$\$\$\$\$\$COUNT\$\$\$\$\$  
 \$\$\$\$\$\$TOTAL\$\$\$\$\$  
 \$\$\$\$\$\$COUNT\$\$\$\$\$

# ASHE COUNTY

TYPE OF WORK: ASPHALT RESURFACING  
MAPS # 1 THROUGH # 2

2023

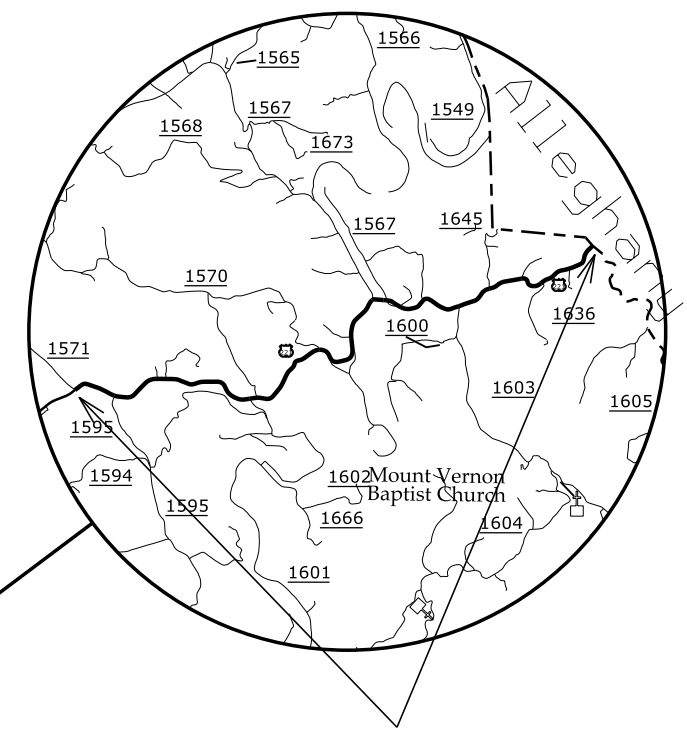
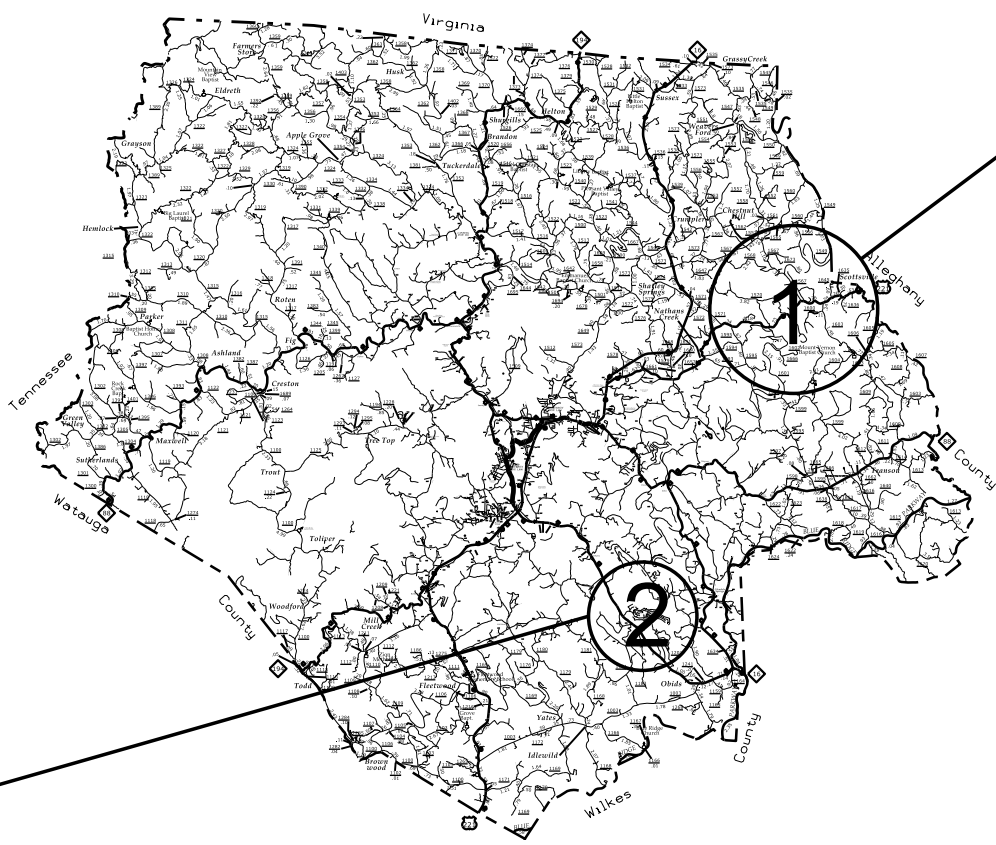
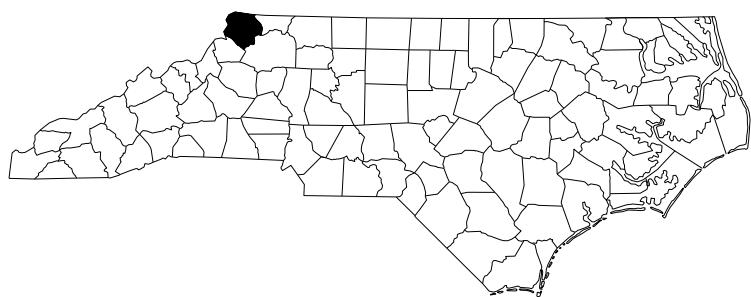

**MAP #1**

\* US 221- (5.05mi.)  
(FROM SR 1571 TO ALLEGHANY  
COUNTY LINE)



**MAP #2**

\* SR 1196 NIKANOR RD. - (0.99mi.)  
(FROM NC 163 TO EOM)

# ASHE COUNTY

TYPE OF WORK: ASPHALT RESURFACING  
MAPS # 3 THROUGH # 7

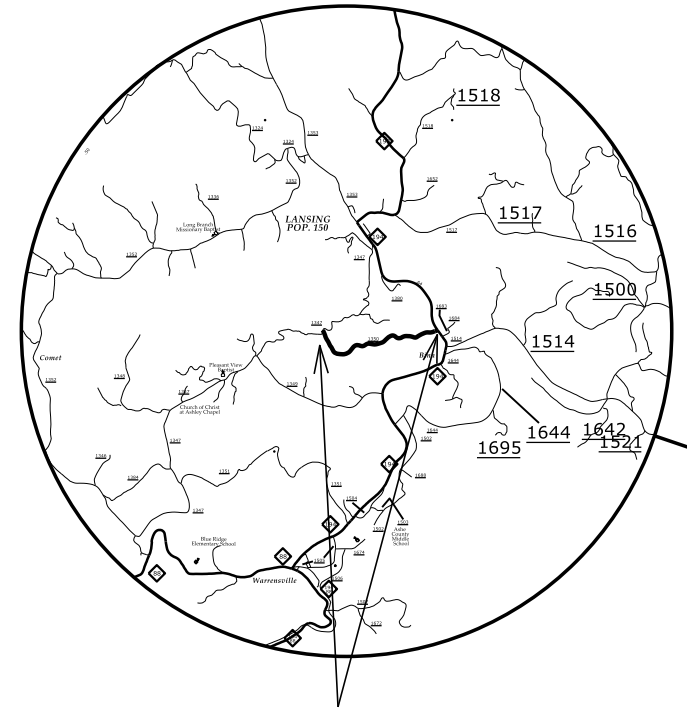

**MAP #3**

\* SR 1350 CHARLEY KING RD. - (1.03mi.)  
(FROM SR 1347 TO BRIDGE #346 OVER  
BIG HORSE CREEK)

**MAP #5**  
\* SR 1583 ASHE CENTRAL SCHOOL RD. - (1.27mi.)  
(FROM SR 1582 TO US 221)

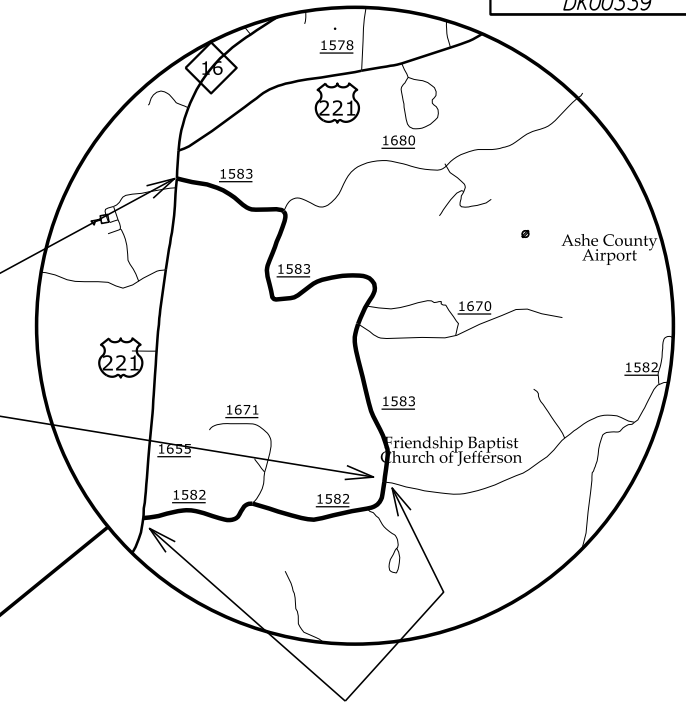

**MAP #4**

\* SR 1582 FRIENDSHIP BAPTIST CH RD. - (0.69mi.)  
(FROM US 221 TO SR 1583)

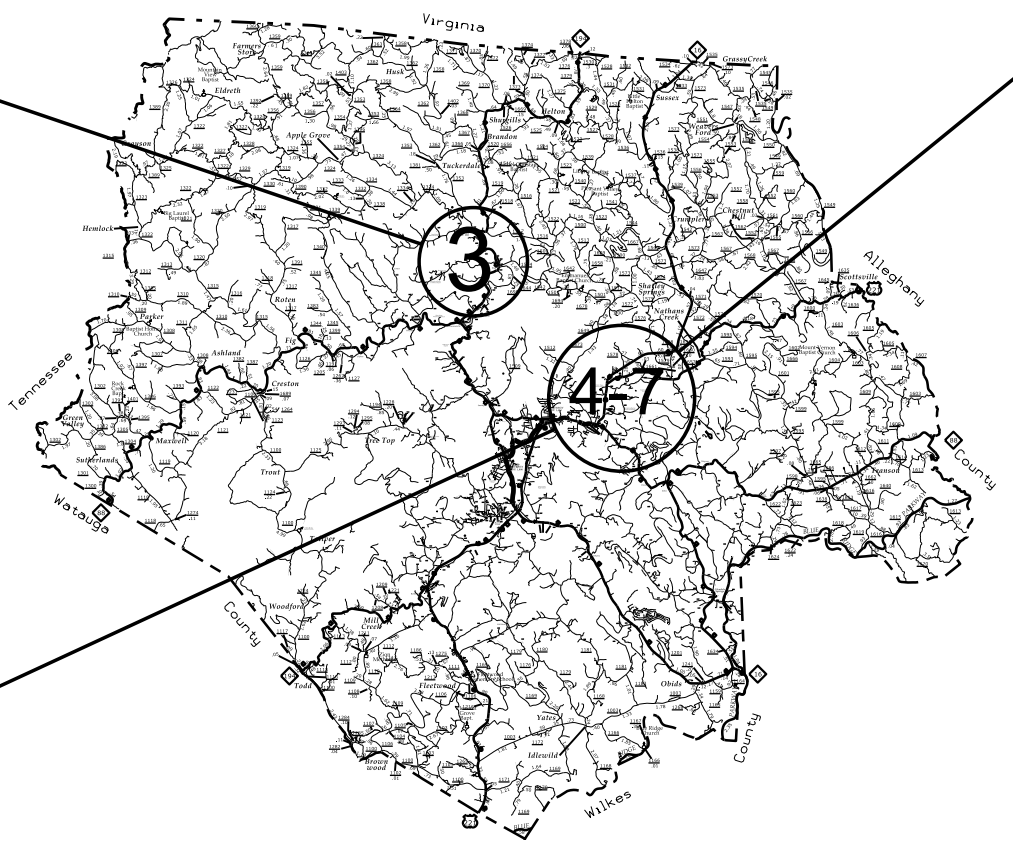

**MAP #7**

\* SR 1671 WITHERSPOON HEIGHTS RD. - (0.26mi.)  
(FROM SR 1655 TO EOM)

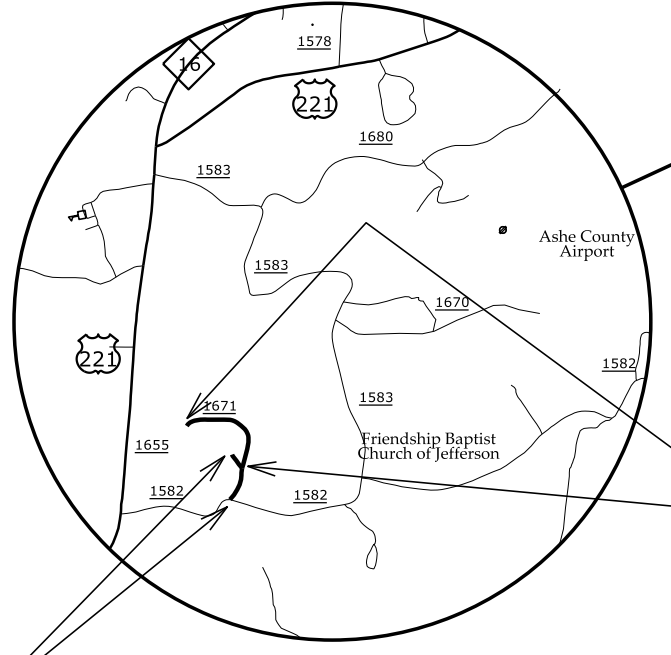

**MAP #6**

\* SR 1655 FRANK WITHERSPOON RD. - (0.13mi.)  
(FROM SR 1582 TO EOM)

- NOTES:  
 1) DETAIL DOES NOT APPLY TO OGAFB AND ULTRA-THIN BONDED WEARING COURSE.  
 2) BACKFILL SHOULDER WITH APPROVED MATERIAL.  
 3) THE SHOULDER WEDGE DEVICE MAY BE DISENGAGED AT PAVED DRIVEWAYS AND SIDE STREETS.

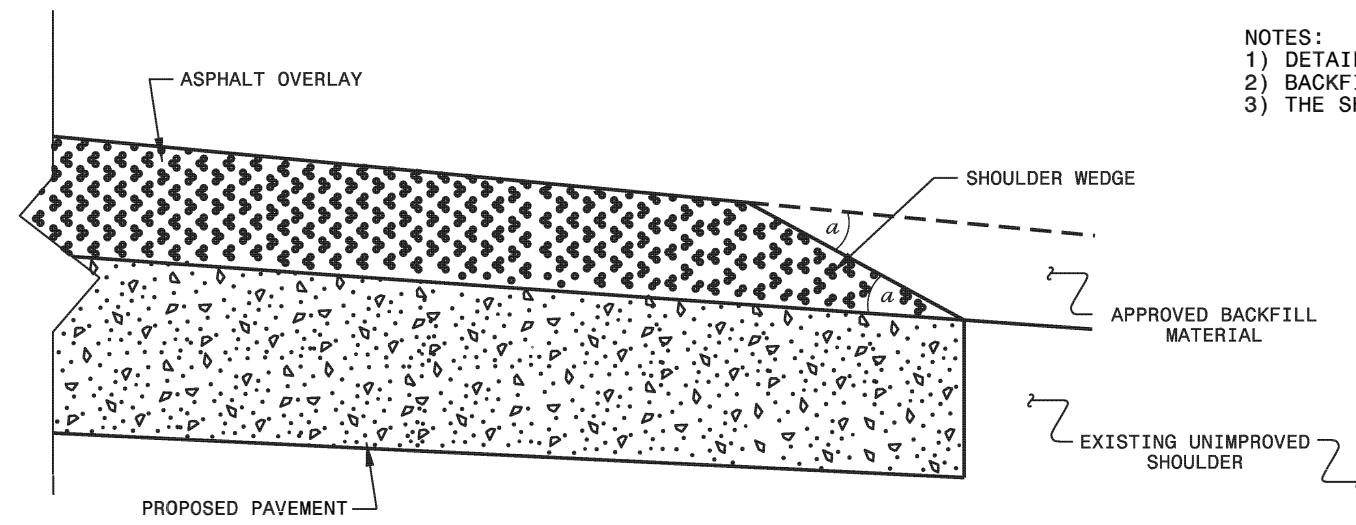

**SHOULDER WEDGE DETAIL**  
 (Resurfacing Projects w/ Widening or  
 with Existing Paved Shoulder having no dropoffs)

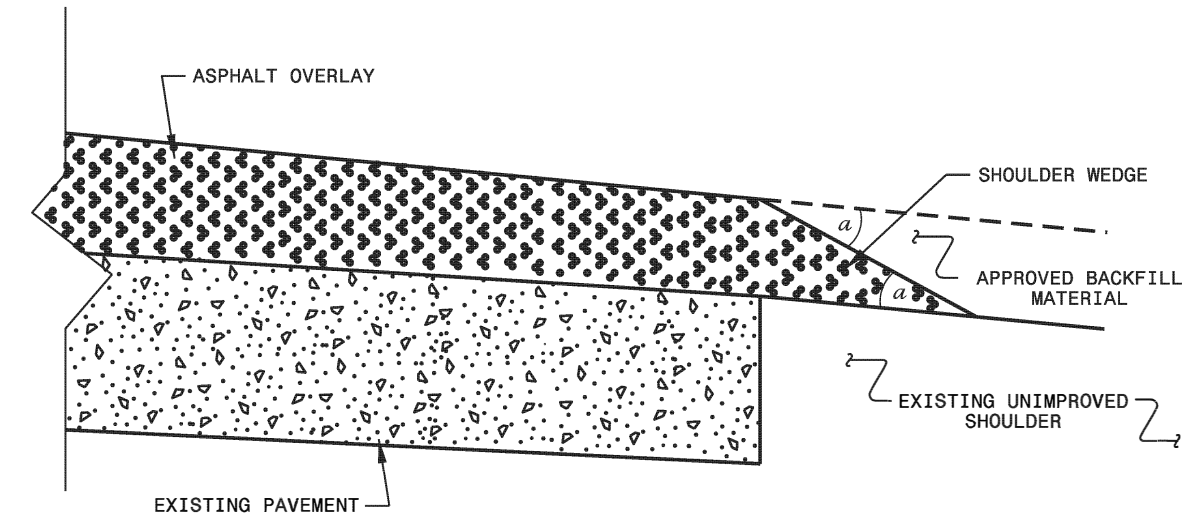

**SHOULDER WEDGE DETAIL**  
 (Resurfacing Projects w/ NO Widening)

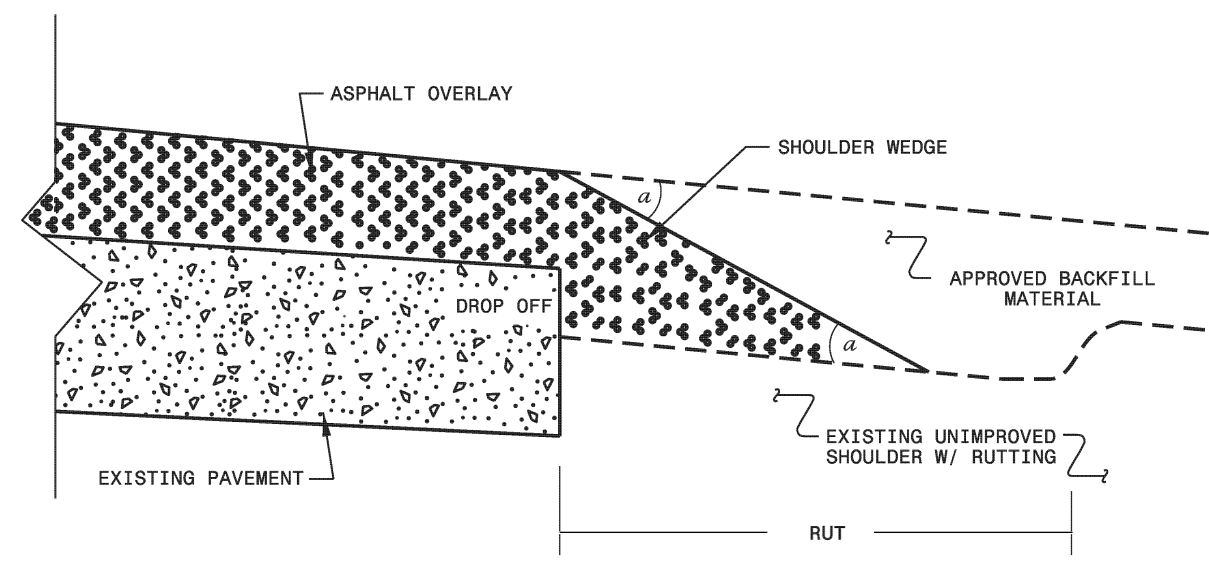

**SHOULDER WEDGE DETAIL**  
 (Resurfacing Adjacent to  
 Rutted Shoulder)

- SHOULDER WEDGE ANGLE = 30°

|  |                  |
|--|------------------|
| <b>CONTRACT STANDARDS<br/>AND DEVELOPMENT UNIT</b>       |                  |
| Office 919-707-6950                                      | FAX 919-250-4119 |
| <b>SHOULDER WEDGE<br/>DETAILS</b>                        |                  |
| ORIGINAL BY: T. SPELL                                    | DATE: 7-19-11    |
| MODIFIED BY:   | DATE: 10/18/12   |
| CHECKED BY:  | DATE:            |
| FILE SPEC.: s:\usr\details\stand\shoulderwedgedetail.dgn |                  |

C:\FFB-2008\lbf\...  
 S:\NDC\3\...  
 .cwlles AT DIV07-3020248

# SIGNING FOR RESURFACING PROJECTS

**LEGEND**  
 ┆ STATIONARY SIGN  
 ← DIRECTION OF TRAFFIC FLOW

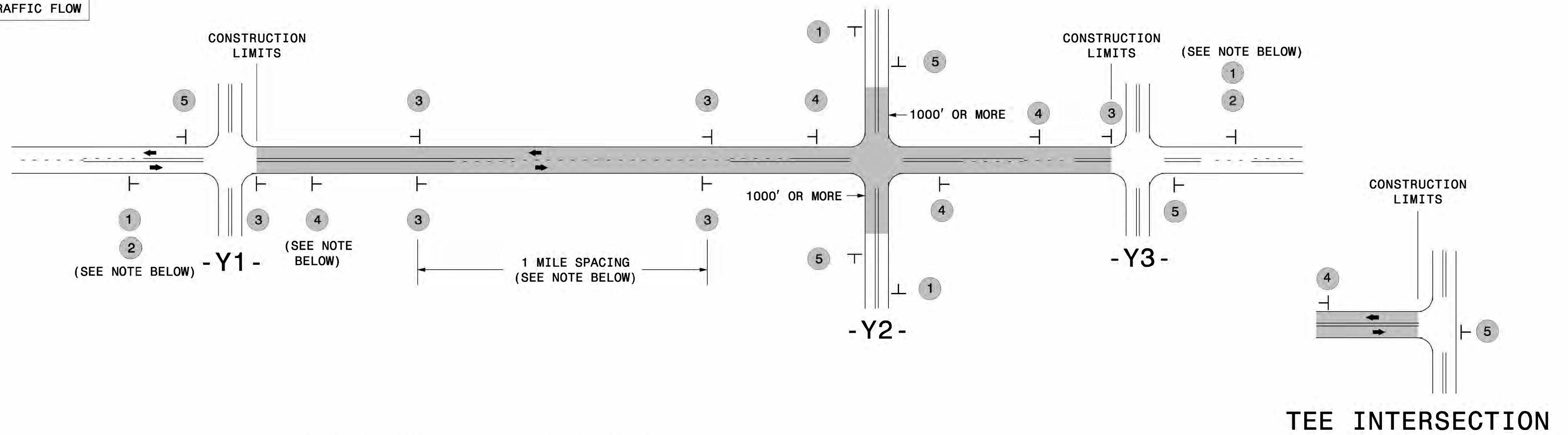

## MAINLINE (-L-) SIGNING

## -Y- LINE SIGNING

|   |   |                           |   |   |
|---|---|---------------------------|---|---|
| SIGNING NOTES AND PLACEMENT PER DIRECTION | 1 | <br>W20-1<br>48" X 48"    | PLACE 1000' PRIOR TO BEGINNING OF CONSTRUCTION LIMITS. ONLY USED ON -Y- LINES IF RESURFACING LIMITS EXTEND 1000' ALONG -Y- LINE.  | <p>NO REQUIRED STATIONARY SIGNING FOR THE FOLLOWING -Y- LINE CONDITIONS:</p> <ol style="list-style-type: none"> <li>1) LESS THAN 1000' OF RESURFACING ALONG -Y- LINE</li> <li>2) SUBDIVISION ROADS</li> <li>3) DEAD END ROADS</li> </ol> <p>WHEN PAVING/CONSTRUCTION ACTIVITIES PROCEED ACROSS AN UNSIGNED -Y- LINE, PORTABLE ADVANCE WARNING SIGNS SHALL BE USED ALONG THE -Y- LINE AS SHOWN BELOW. REMOVE UPON COMPLETION OF WORK.</p> <div style="display: flex; justify-content: space-around;"> <div style="text-align: center;"> <br/>         W20-1<br/>         48" X 48"       </div> <div style="text-align: center;"> <br/>         W20-7 A<br/>         48" X 48"       </div> </div> <p>PLACED 500' IN ADVANCE OF FLAGGER.      PLACED 250' IN ADVANCE OF FLAGGER.</p> |
|   | 2 | <br>W7-3aP<br>24" X 18"   | #2 SIGN ONLY USED WHEN CONSTRUCTION LIMITS ARE 2 OR MORE MILES IN LENGTH. ROUND UP TO NEXT WHOLE NUMBER. (NO FRACTIONAL OR DECIMAL NUMBERS)   |   |
|   | 3 | <br>SP 13107<br>48" X 48" | <ul style="list-style-type: none"> <li>- PLACE INITIALLY AT THE CONSTRUCTION LIMITS AND SPACE 1 MILE APART THEREAFTER.</li> <li>- AT TEE INTERSECTIONS INSTALL INITIALLY 1/2 MILE FROM INTERSECTION AND SPACE 1 MILE APART THEREAFTER.</li> </ul>   |   |
|   | 4 | <br>SP 13106<br>48" X 48" | <ul style="list-style-type: none"> <li>- THESE ARE FOR -Y- LINES THAT ARE "THROUGH" ROADWAYS.</li> <li>- DEAD END AND SUBDIVISION ROADS ARE NOT "THROUGH" ROADWAYS.</li> <li>- INSTALL 500' +/- FROM EACH -Y- LINE APPROACH AS SHOWN ABOVE.</li> <li>- FOR MULTIPLE -Y- LINES THAT ARE SEPARATED BY 0.25 MILES OR LESS, TREAT AS A SINGLE UNIT AND INSTALL WITHIN 500' OF EACH APPROACH.</li> <li>- A MAXIMUM OF 2 SIGN SETS PER MILE. DO NOT INSTALL WHEN -Y- LINES ARE WITHIN 0.5 MILES FROM "END ROAD WORK" SIGN.</li> <li>- FOR TEE INTERSECTIONS, INSTALL WITHIN 500' +/- OF THE INTERSECTION ALONG -L- LINE.</li> </ul> |   |
|   | 5 | <br>G20-2 A<br>48" X 24"  | PLACE 500' FOLLOWING THE END OF CONSTRUCTION LIMITS OR AS SHOWN WHEN WORK ENDS AT A 3-WAY TEE INTERSECTION.   |   |

THE ABOVE SIGNS ARE ALL THAT ARE REQUIRED FOR A CONTRACTOR TO BEGIN A RESURFACING CONTRACT. ANY ADDITIONAL SIGNS REQUESTED BY NCDOT DIVISIONS SHALL BE INSTALLED WITHIN 7 BUSINESS DAYS OF THE START OF CONTRACT WORK.

**MAPS LESS THAN 2 MILES**

FOR RESURFACING MAPS WITH CONSTRUCTION LIMITS LESS THAN 2 MILES IN LENGTH, NO STATIONARY SIGNS ARE REQUIRED. USE PORTABLE "ROAD UNDER CONSTRUCTION" OR "ROAD WORK AHEAD" SIGNS IN LIEU OF STATIONARY ADVANCE WARNINGS SIGNS.

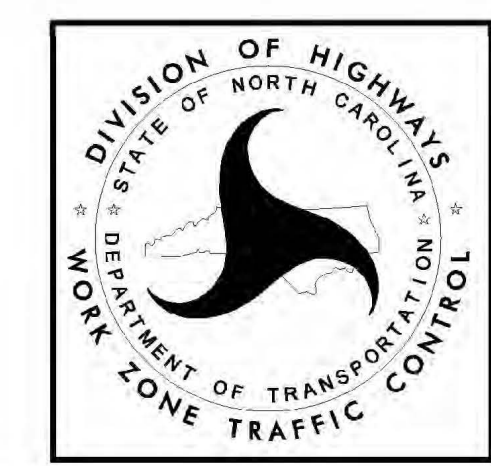

**ADVANCE WARNING SIGNS FOR RURAL AND SUBURBAN 2-LANE ROADWAY RESURFACING**

5/15/2017 S:\1\MD\WZ\IC\Resurfacing\2L2W & AS1 Resurfacing Details\Resurfacing\_AdvWarn\_2Ln.dgn User:keals